



Series 4791- 4793 GP and HP/HT Vessels: 25 - 100 mL



Model 4791, 25 mL General Purpose Vessel



4793HP/HT, 100 mL Vessel

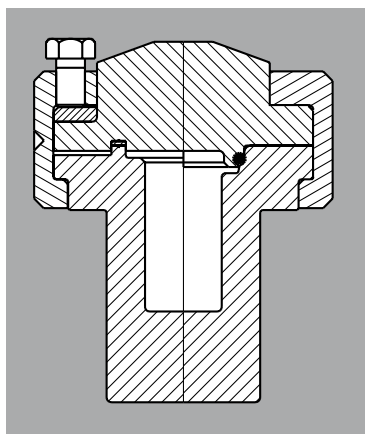

4791 Cross Section (Showing Flat Gasket and O-ring Closure)

General Purpose 4790 Series Vessels come with dip tube, three valves, gage, rupture disc, and thermocouple. The HP/HT versions include one valve as standard.

Series 4791 - 4793 Pressure Vessel Specifications			
Shaded bar indicates specifications that change within series.			
General Purpose Vessels			
Model Number	4791(Q)*	4792(Q)*	4793(Q)*
Sizes, mL	25	50	100
Maximum Pressure (MAWP)	3000 psi (200 bar)		
Maximum Temperature			
with FKM O-Ring	225 °C		
with FFKM O-Ring	275 °C		
with PTFE - Flat Gasket	350 °C		
Valve Connections	3 - 1/8" NPT Male		
Pressure Gage Size / Range	3.5 inches / 0-3000 psi (200 bar)**		
Heater			
Catalog Number	A2236HC	A2236HC	A2237HC
Heater Power Watts	400	400	350
Heater Style	Clamp-on	Clamp-on	Mantle
High Temperature / High Pressure Vessels			
Model Number	4791HP/HT	4792HP/HT	4793HP/HT
Sizes, mL	25	50	100
Maximum Pressure (MAWP)	5000 psi (350 bar)		
Maximum Temperature			
with Grafoil - Flat Gasket	500 °C		
Valve Connections	3 - "A" Socket		
Pressure Gage Size / Range	3.5 inches / 0-5000 psi (350 bar)*		
Heater			
Catalog Number	A3240HC6		
Heater Power Watts	700		
Heater Style	Ceramic Fiber		
Common to these General Purpose and High Temperature / High Pressure Models			
Closure	Split-Ring (6 Cap Screws)		
Temperature Measurement	Fixed Thermocouple		
Additional Fittings	Dip Tube and Rupture Disc		
Vessel Dimensions			
Inside Diameter, inches	1.0	1.3	1.3
Inside Depth, inches	2.0	2.3	4.6
Weight of Vessel, pounds	7	7	8
*Add the suffix Q to these catalog numbers to specify vessels with an O-Ring seal and a split ring pair without cap screws			
**Other options available. See Options Section and Ordering Guide.			